

UMS Portable Injection Units U.S. Patent 6,994,810 B2

W188 N11707 Maple Road
 Germantown, WI 53022 USA
 Phone: (262) 255-5790
 Fax: (262) 255-7206
 E-Mail: contact@mgstech.com

www.mgstech.com
www.multishot.com

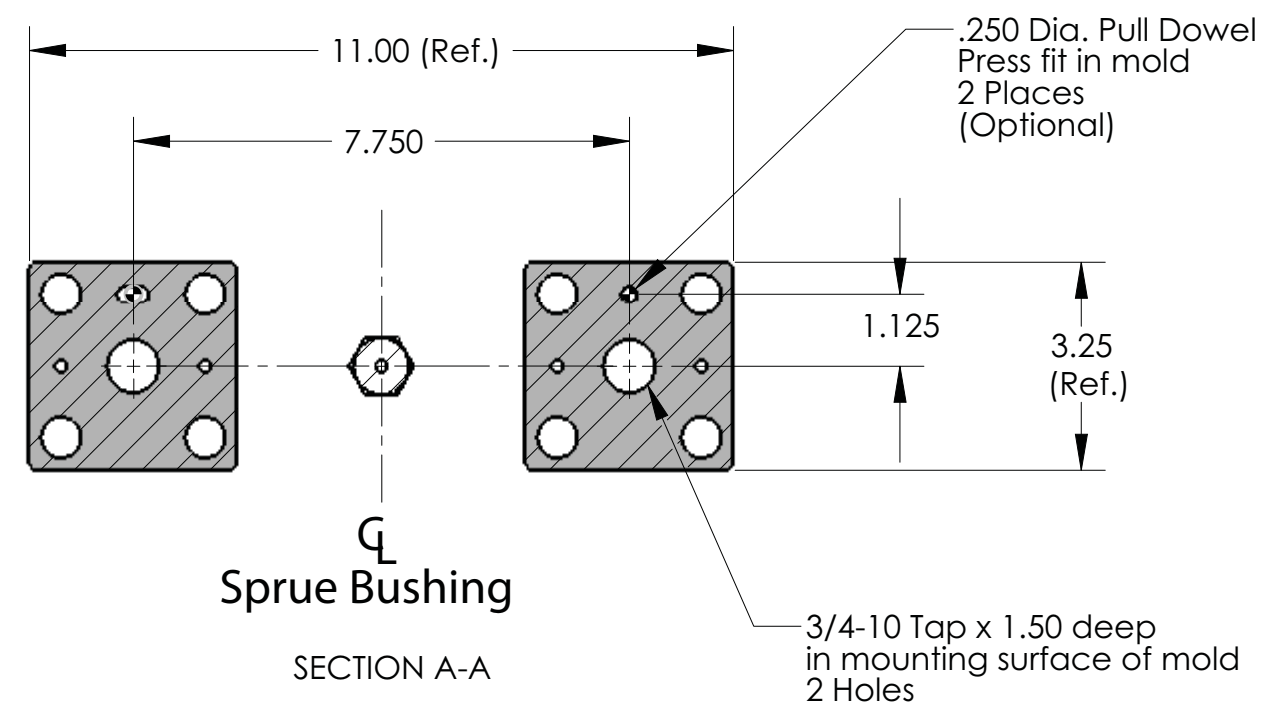

Mounting Hole Pattern
Option #1
For injecting behind parting line

Option #1 requires the sprue bushing to be located a minimum of 1.625" from the parting line.

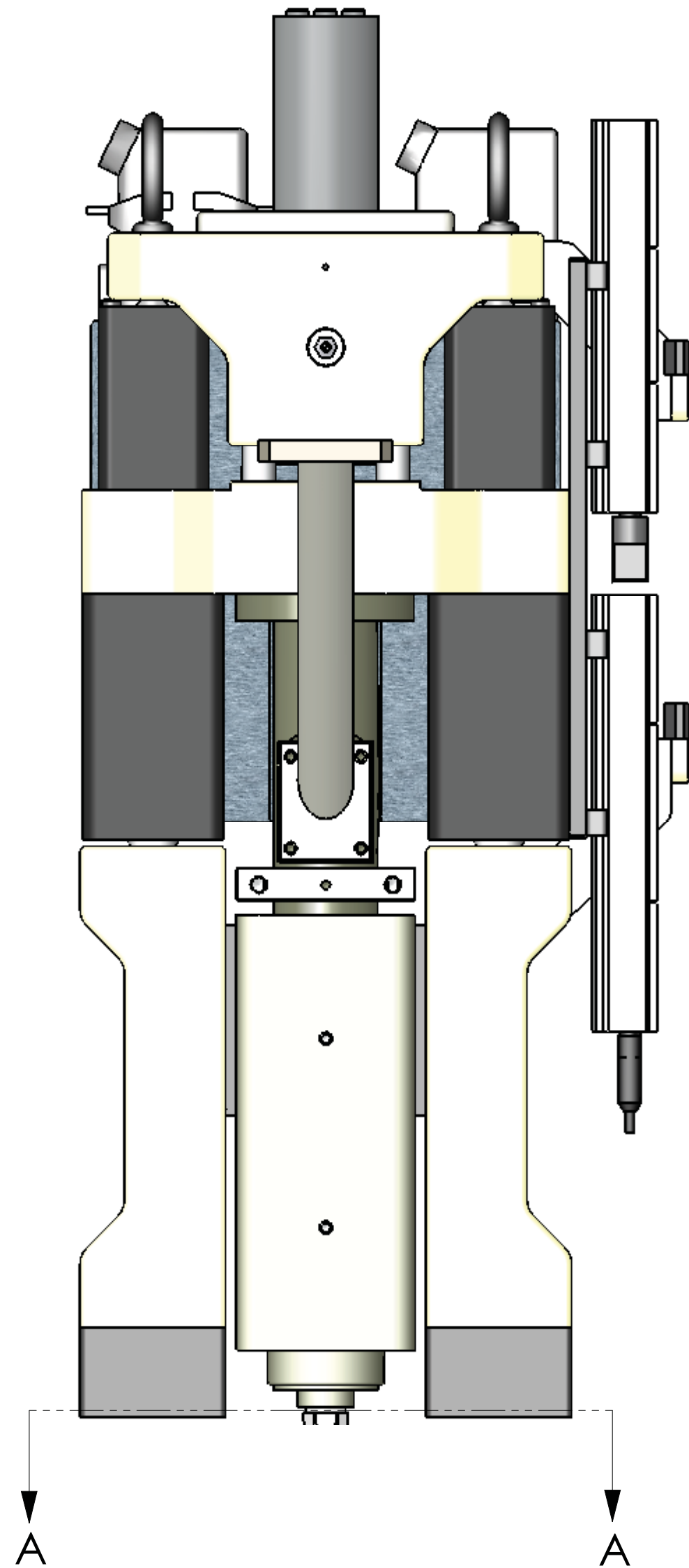

MOUNTING OPTION 1

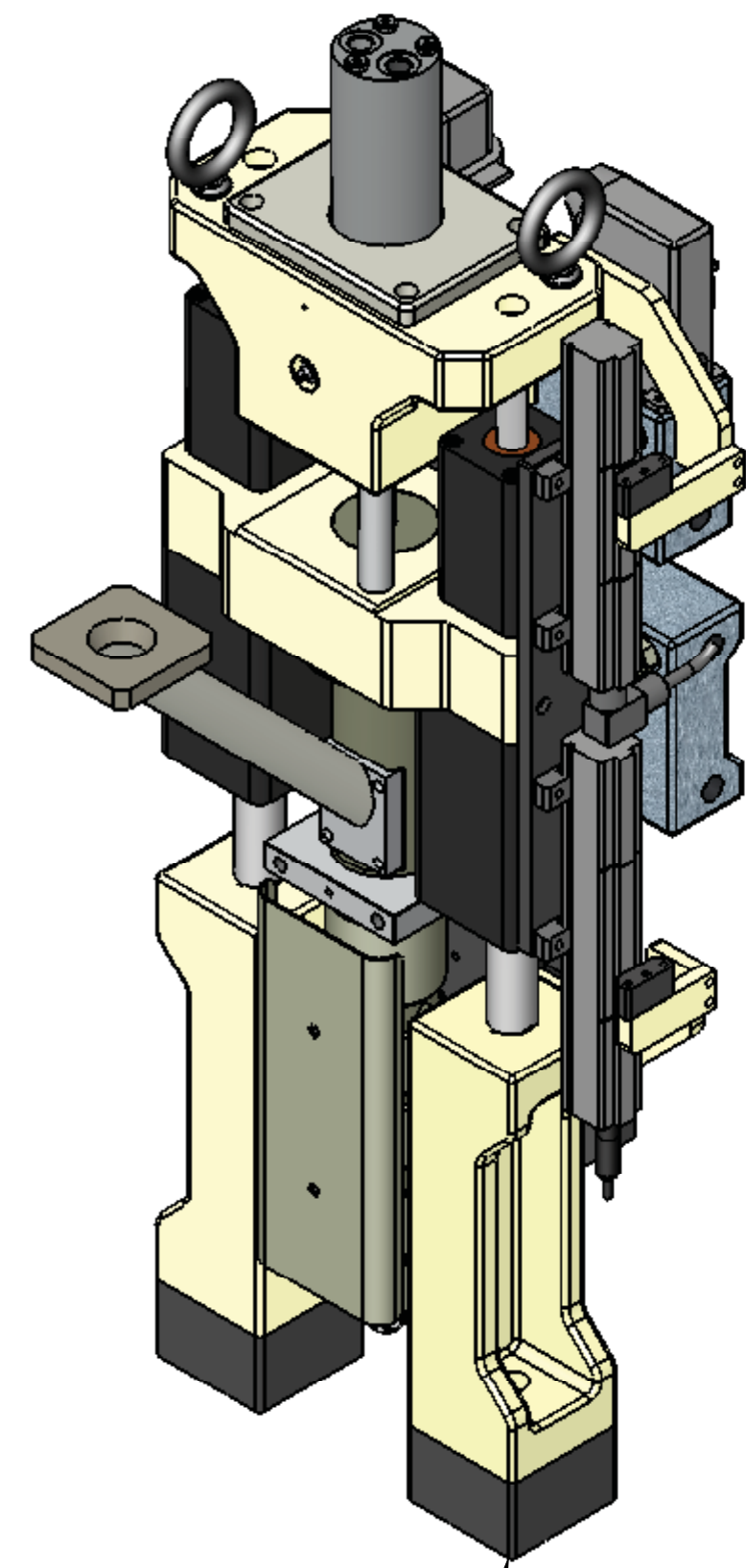

Scale: 1/4

Standard riser shown.
Optional riser designs can be provided to accommodate shutoff nozzles, filter packs, or custom applications. Consult MGS for details.

MOUNTING OPTION 2

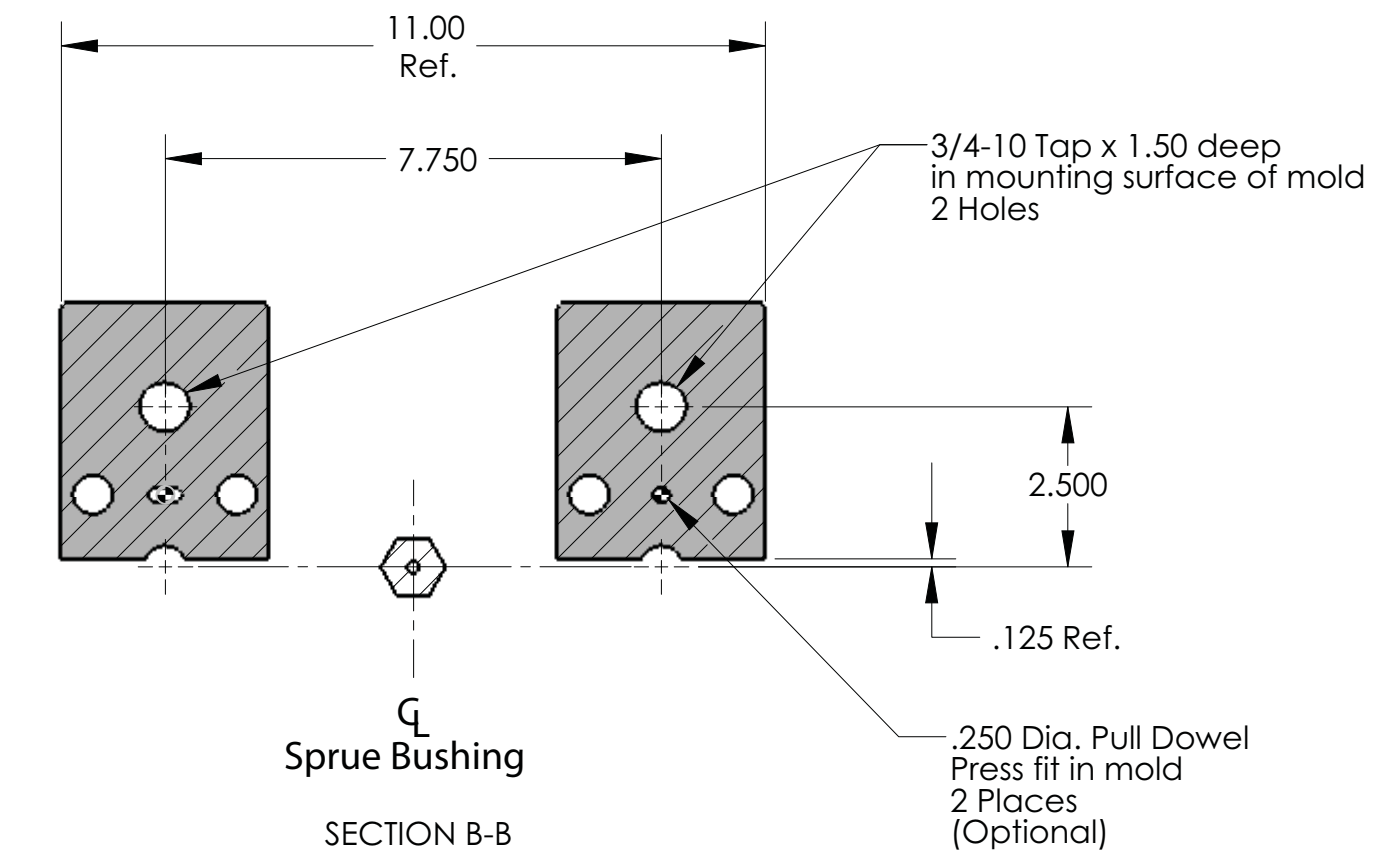

Mounting Hole Pattern
Option #2
Recommended for injecting on parting line

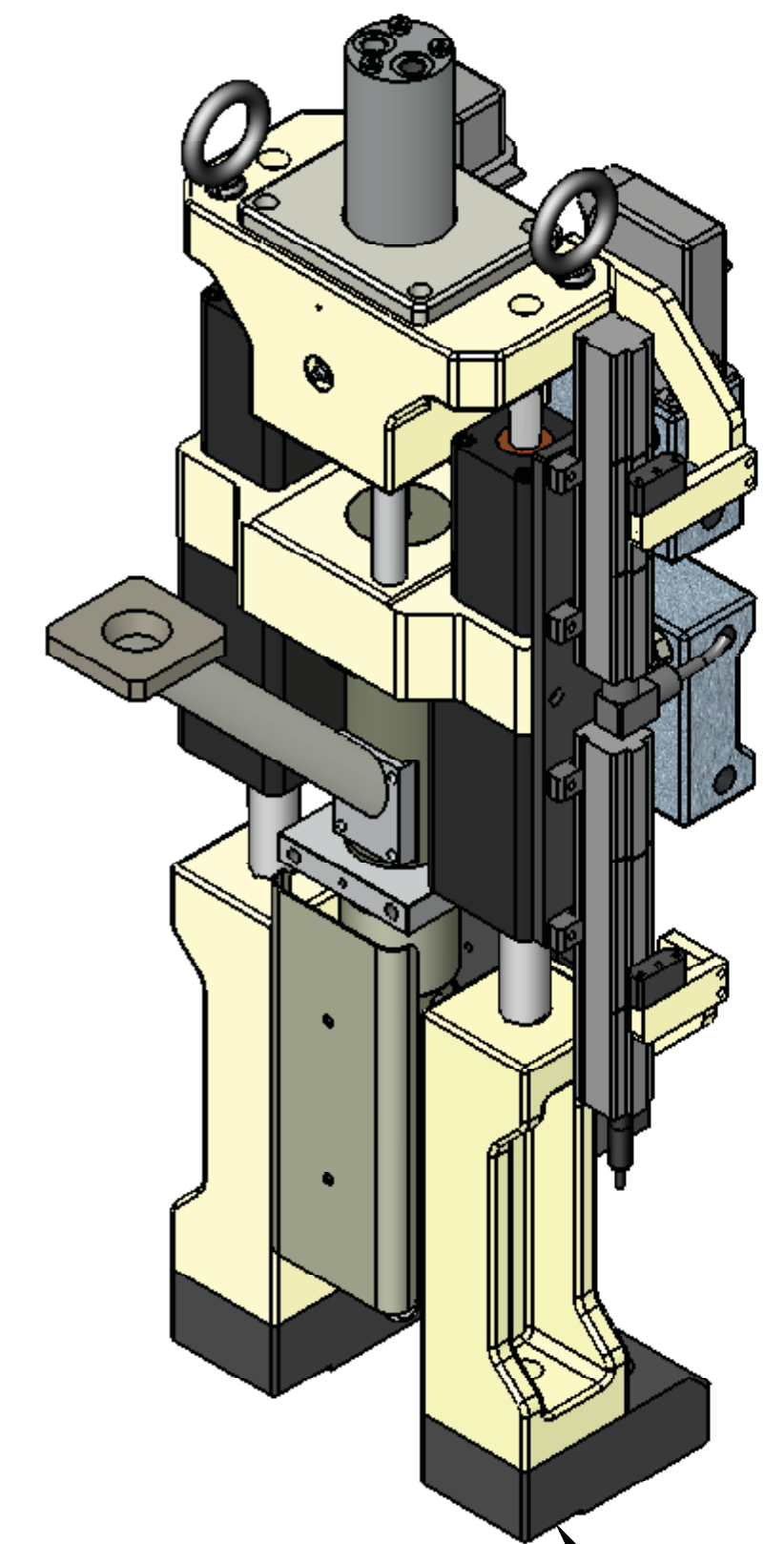
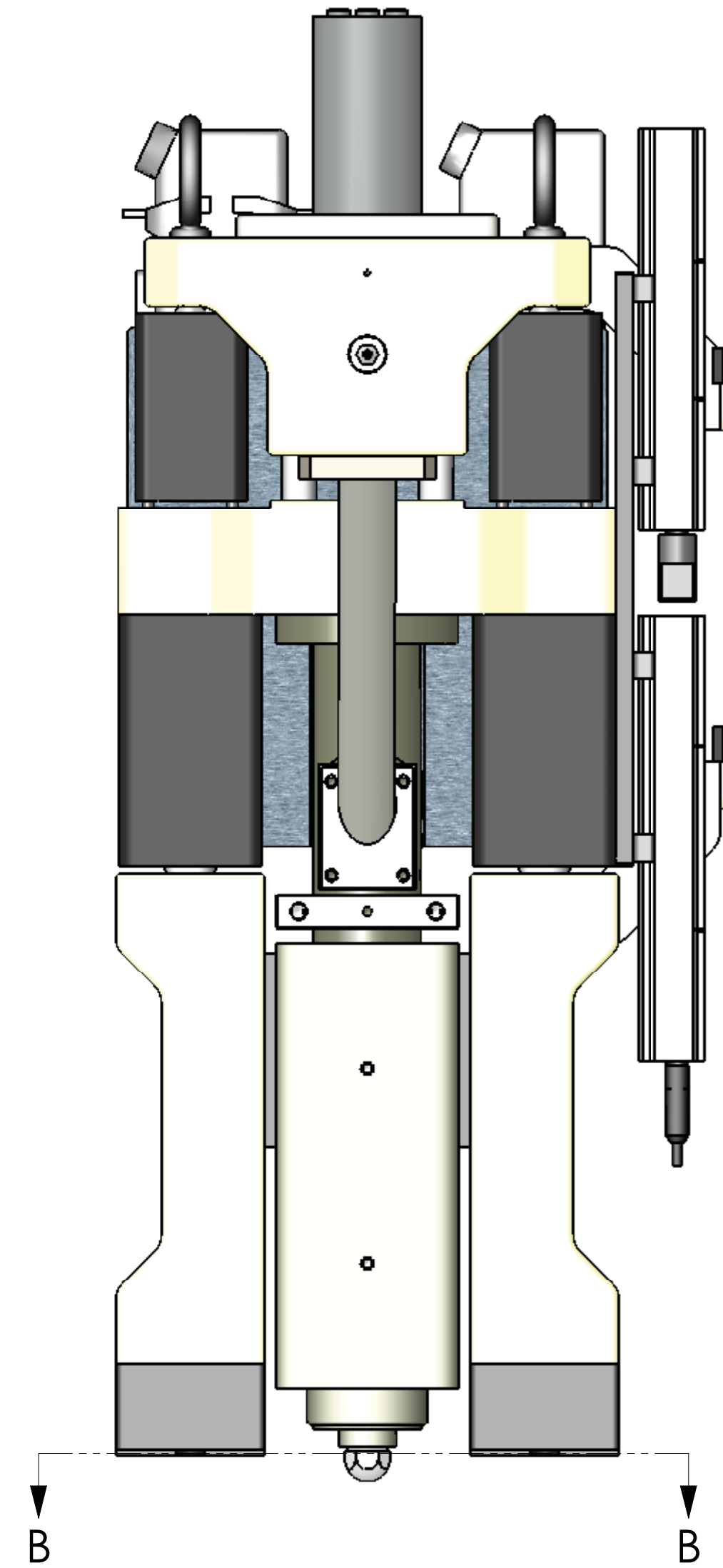

Scale: 1/4

Offset Riser
Relieved for
parting line injection



UMS Portable Injection Units U.S. Patent 6,994,810 B2

W188 N11707 Maple Road
Germantown, WI 53022 USA
Phone: (262) 255-5790
Fax: (262) 255-7206
E-Mail: contact@mgstech.com

www.mgstech.com
www.multishot.com